

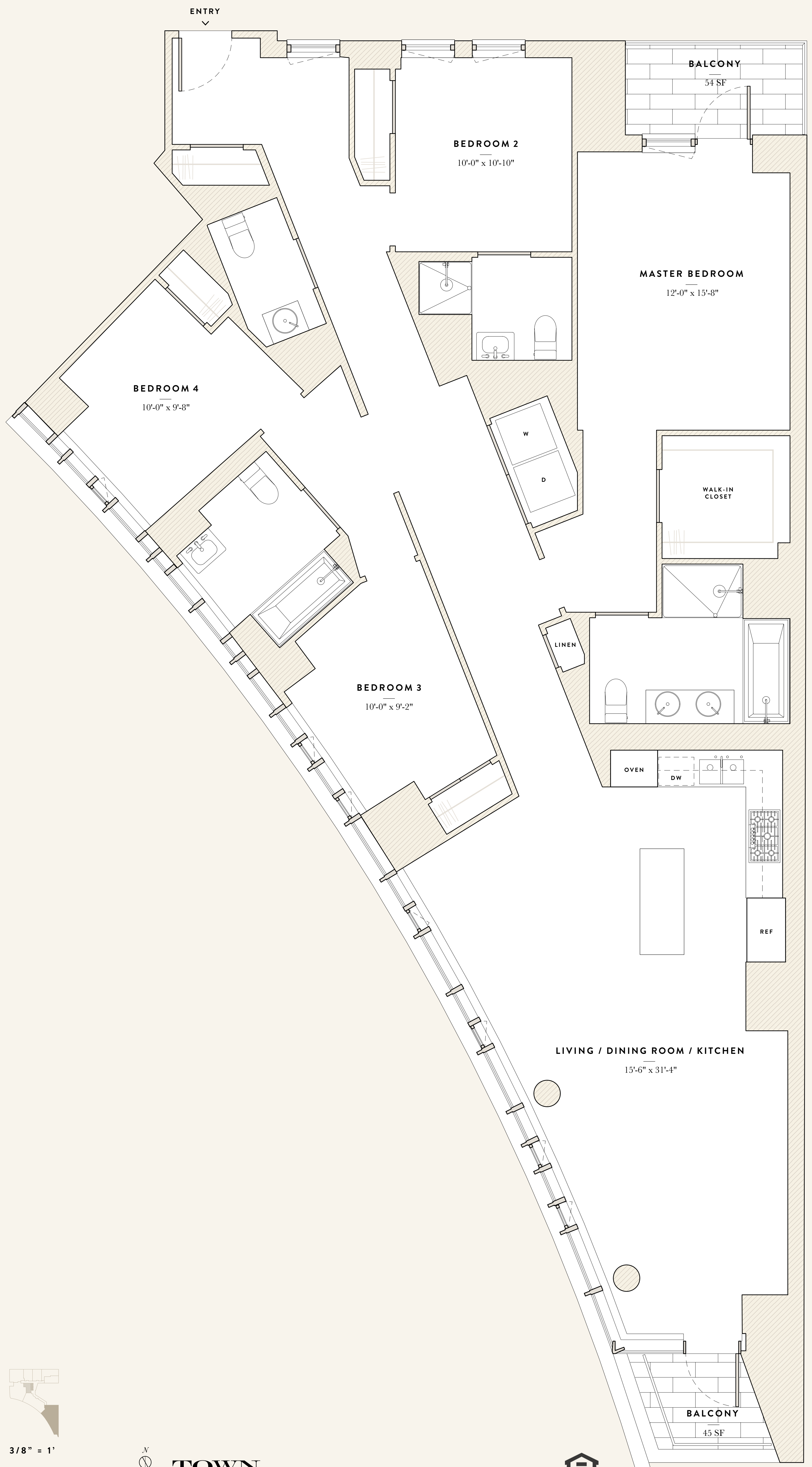

Sleek and fresh with sweeping views, dynamic interior spaces and private balconies redefine life on Central Park.



ALWAYS
HOME

FOUR BEDROOMS 2,114 SF / 196 M²
THREE BATHS 99 SF EXTERIOR
POWDER ROOM

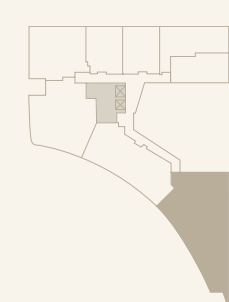

3/8" = 1'

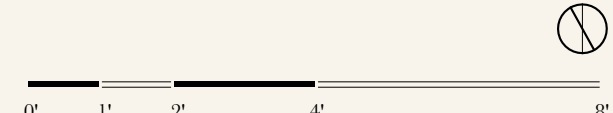

TOWN
NEW DEVELOPMENT



3G 4G 5G
6E 7E

All dimensions are approximate and subject to normal construction variances and tolerances. Square footage exceeds the usable floor area and there are no subtractions for common elements that lie within a residence, i.e. columns, shafts, vent stacks, etc. Sponsor reserves the right to make changes in accordance with the Offering Plan. Plans and dimensions may contain minor variations from floor to floor. All measurements on floor plans of room sizes are taken to the longest points of the room. The complete terms are in an Offering Plan available from the Sponsor – file number CD 150033. Sponsor: Crescent 110 Equities, LLC. 316 West 118th Street, New York, New York 10026. Exclusive sales and marketing by TOWN New Development Sales & Marketing, LLC, a licensed real estate broker. 33 Irving Place, New York, New York 10003.